

12-/24-Port Gigabit IEEE 802.3at High Power Injector Hub

HPOE-1200G

HPOE-2400G



Presentation Outlines

- ◆ **Product Overview**
- ◆ **Product Benefits**
- ◆ **Product Features**
- ◆ **Applications**
- ◆ **Comparison**
- ◆ **Appendix**

HPOE-1200G



HPOE-2400G



Product Overview

◆ The 12-/24-port POE Injector Hub Family

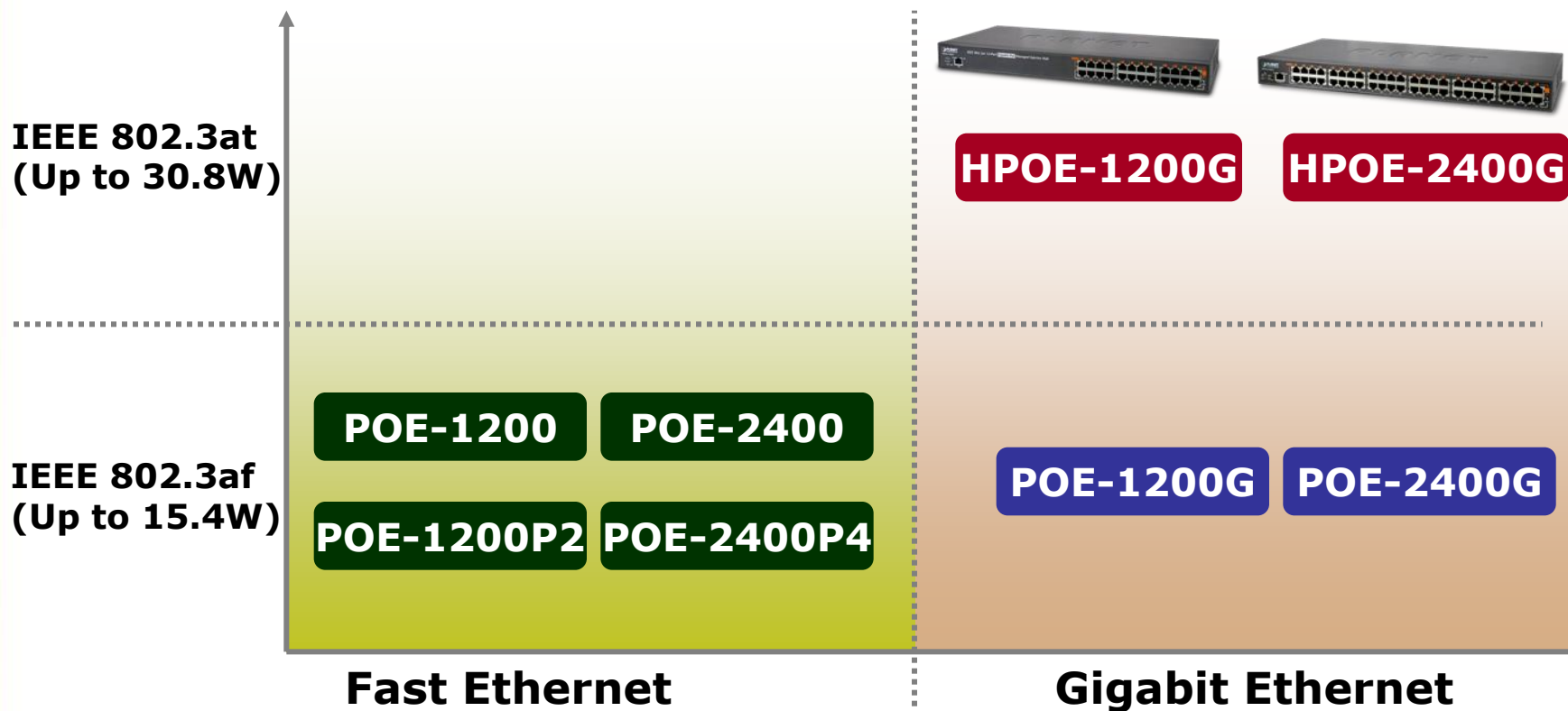

Product Overview

- ◆ **What are the differences between IEEE 802.3af and IEEE 802.3at?**
 - ✓ **IEEE 802.3af** offers a maximum of **15 watts**.
 - ✓ **IEEE 802.3at** offers up to **30 watts**, more power than IEEE 802.3af, and can drive high power consumption PoE device, such as PTZ / speed dome camera.

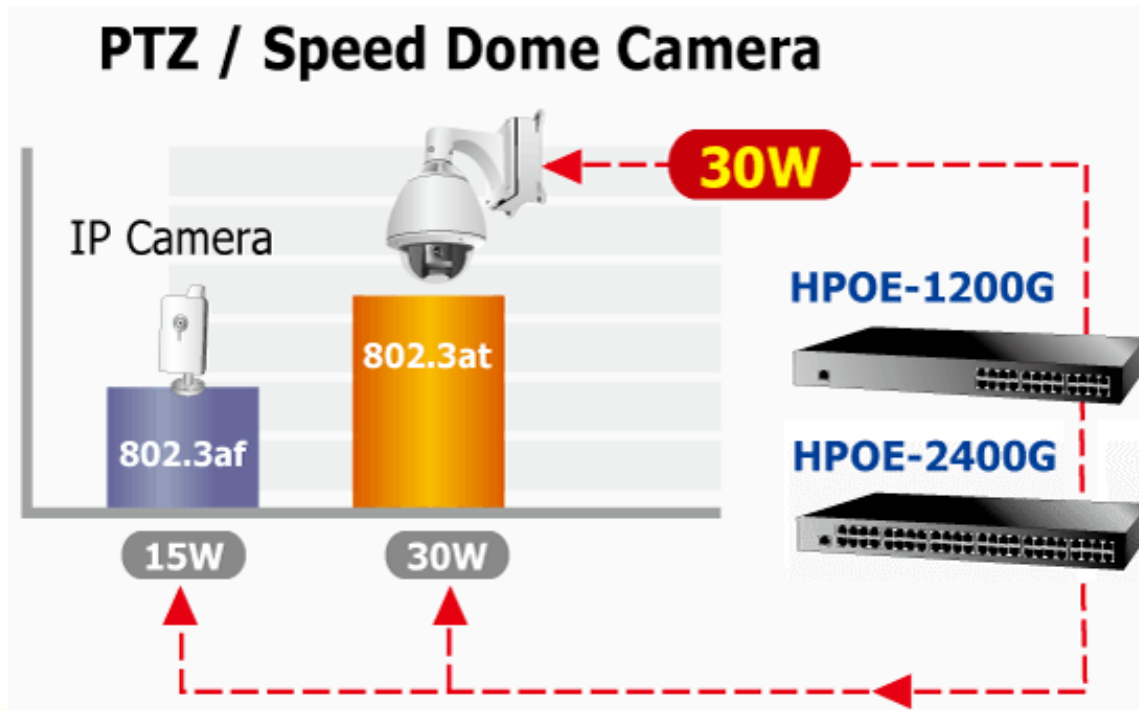

Product Overview

◆ HPOE-1200G Front Panel - Interface

- ✓ 24-Port 10/100/1000Mbps with POE Ports
 - 12 ports on the upper stack are data and power ports.
 - 12 ports on the lower stack are data ports.
- ✓ 1-Port 10/100Mbps management port.
- ✓ **LEDs**
 - Power LED
 - Power Failure LED
 - Fan Failure LED
 - Link / Activity LED
 - PoE-in Use LED
- ✓ Reset Button



Product Overview

◆ Rear Panel of HPOE-1200G

- ✓ 100~240V AC, universal power supply
- ✓ 1 power switch
- ✓ 2 cooling fans

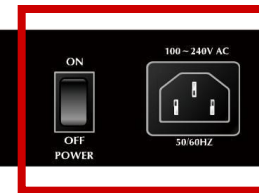
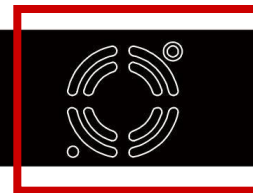
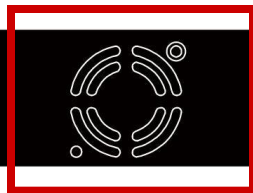

Product Overview

◆ HPOE-2400G Front Panel - Interface

- ✓ 48-Port 10/100/1000Mbps with POE Ports
 - 24 ports on the upper stack are data and power ports.
 - 24 ports on the lower stack are data ports.
- ✓ 1-Port 10/100Mbps management port.

LEDs

- Power LED
 - Power Failure LED
 - Fan Failure LED
 - Link / Activity LED
 - PoE-in Use LED
- ✓ Reset Button



Product Overview

◆ Rear Panel of HPOE-2400G

- ✓ 100~240V AC, universal power supply
- ✓ 1 power switch
- ✓ 4 cooling fans (3 on rear panel and 1 on inner case)

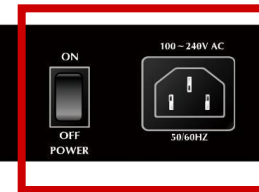
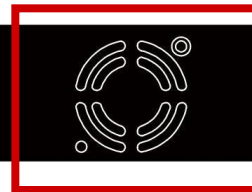
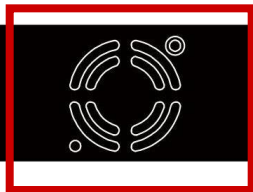

Key Benefits

- ◆ **Cost-effective 12-/24-Port Gigabit Mid-Span Power over Ethernet Injector Hub**
- ◆ **Complies with IEEE 802.3af / IEEE 802.3at 52V DC per port maximum 15.4 / 30.8 watts**
- ◆ **Provides PoE Power Schedule feature to save power**
- ◆ **Automatically detects powered device and consumption level**
- ◆ **Remote PoE Power management by WEB**
- ◆ **Provides PoE per port power feeding limit and priority**
- ◆ **Provides temperature over protection to prevent device damage**
- ◆ **Provides SNMP and SNMP trap**
- ◆ **Provides local system log and remote system log for management**
- ◆ **19-inch rack mountable; 1U height**

Product Feature

◆ Hardware of HPOE-1200G

- ✓ **24-Port 10/100/1000Mbps RJ-45 interface**
 - **12 ports** on the upper stack are **Data and Power** ports
 - **12 ports** on the lower stack are **Data** ports
- ✓ **1 x 10/100Mbps RJ-45 Management port**
- ✓ **Fan failure LED on the front panel for alert**
- ✓ **PoE power failure LED on the front panel for alert**
- ✓ **Reset button on the front panel**

Product Feature

◆ Hardware of HPOE-2400G

- ✓ **48-Port 10/100/1000Mbps RJ-45 interface**
 - **24 ports** on the upper stack are **Data and Power** ports
 - **24 ports** on the lower stack are **Data** ports
- ✓ **1 x 10/100Mbps RJ-45 Management port**
- ✓ **Fan failure LED on the front panel for alert**
- ✓ **PoE power failure LED on the front panel for alert**
- ✓ **Reset button on the front panel**



Product Features

◆ Power over Ethernet

- ✓ Complies with IEEE 802.3af / IEEE 802.3at Power over Ethernet Mid-Span PSE
- ✓ PoE Pin Assignment 4/5(-), 7/8(+)
- ✓ 12 Gigabit copper ports with PoE injector (HPOE-1200G)
- ✓ 24 Gigabit copper ports with PoE injector (HPOE-2400G)
- ✓ 52VDC, 15.4 / 30.8 watts per port PoE power output
- ✓ 360-watt PoE power budget for HPOE-1200G
- ✓ 720-watt PoE power budget for HPOE-2400G
- ✓ Automatically detects powered device and consumption levels
- ✓ Circuit protection to prevent power interference between ports

Model		HPOE-1200G	HPOE-2400G
PoE Budget		360 watts	720 watts
PoE Ability	Number of Class 2 PD @ 7.3 watts	12	24
	Number of class 3 PD @ 15.4 watts	12	24
	Number of class 0, 4 PD @ 30.8 watts	12	24
Input Power		100~240V AC	100~240V AC

Product Feature

◆ PoE Management

- ✓ PoE Admin function enable / disable
- ✓ Total PoE power budget control
- ✓ Per port PoE power schedule
- ✓ Per port PoE function enable / disable
- ✓ Per port IEEE 802.3at / 802.3af mode switch
- ✓ PoE port power feeding with priority
- ✓ Per PoE port power limit
- ✓ PD classification detection automatically
- ✓ PD alive check function
- ✓ PoE Per port usage status
- ✓ Over temperature protection
- ✓ PoE temperature threshold
- ✓ PoE power usage threshold

Product Feature - UI

PoE Configuration

System PoE Admin Mode	Enable <input type="checkbox"/>
Power Supply	52 V
PoE Temperature Unit 1	28°C / 82°F
PoE Temperature Unit 2	27°C / 81°F
Power Limit Mode	Consumption <input type="checkbox"/>
Over Temperature Protection	Enable <input type="checkbox"/>
Temperature Threshold	50 °C

PoE function mode switch.

PoE function switch.

This value is set to relate Over Temperature Protection.

System temperature detection.

Per port PoE function switch.

Over Temperature Protection switch.

Power Allocation 0% 0 W / 720 W

Port	PoE Function	Power Mode	Priority	Device Class	Current Used [mA]	Powered Used [W]	Power Limit[W]
1	Enable <input type="checkbox"/>	3 at <input type="checkbox"/>	Critical <input type="checkbox"/>	--	0	0	30.8
2	Enable <input type="checkbox"/>	3 at <input type="checkbox"/>	Critical <input type="checkbox"/>	--	0	0	30.8
					0	0	30.8
					0	0	30.8

Power mode offers per port AT/AF mode changing.

Per PoE port priority switch.

Per PoE port power allocation.

Product Features – PD Alive Check

◆ Intelligent Powered Device Alive-Check

- ✓ The HPOE-1200G/HPOE-2400G can be configured to **monitor connected PD (Powered Device) status in real-time** via ping action.
- ✓ Once the PD stops working and responding, the HPOE-1200G/HPOE-2400G will resume the PoE port power and bring the PD back to work.

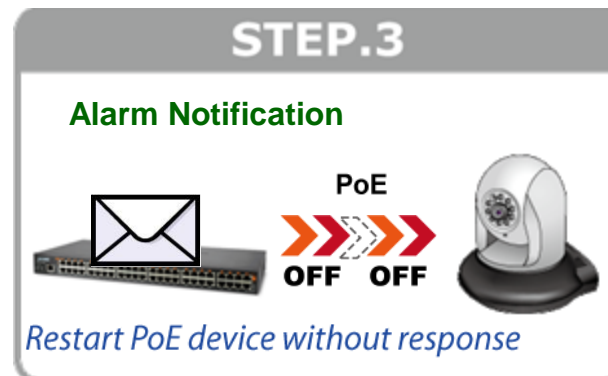

Product Features - Over Temperature Protection

◆ Over Temperature Protection Enabled

Auto adjust PoE budget

HPOE-1200G
HPOE-2400G



Environment
Temperature

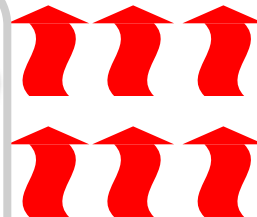

STAGE-2

STAGE-1

Data + Power

PD:
PoE IP Cam

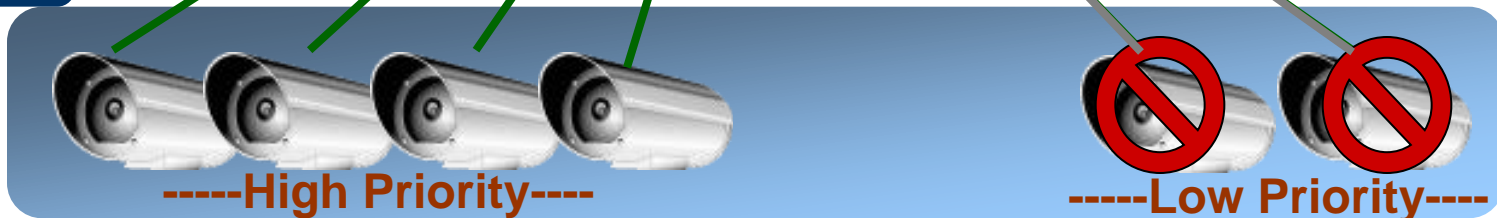

Avoid overheating PoE Hub owing to high temp.

Product Feature – PoE Power Schedule

◆ PoE Power Schedule

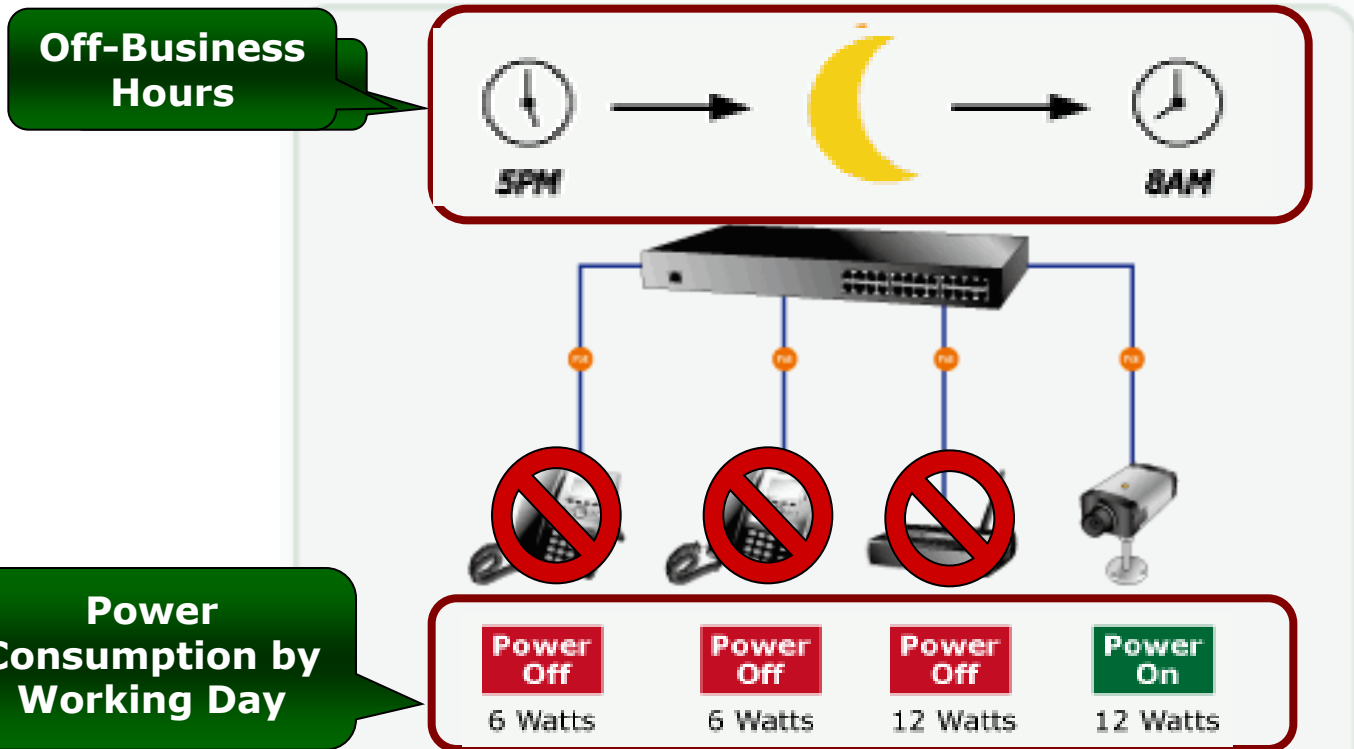

Total saved 24 watts/hr during off hours
Total saved 10800 watts/month

Product Features – PoE Power Schedule

◆ 3 steps for configuring PoE schedule

- 1 Choose the port you want to include in the profile.
- 2 Decide what time to power the PoE device by the Hub.
- 3 Enable the profile.

Up to 24 profiles for you apply to different PoE schedule requirements.

Product Features – PoE Power Schedule

PoE Schedule Profile

PoE Profile	Function	Include Port												PoE Schedule Page	
		1	2	3	4	5	6	7	8	9	10	11	12	Next >>	Show
1	Enable	<input type="checkbox"/>	<input type="checkbox"/>	<input checked="" type="checkbox"/>	<input type="checkbox"/>	<input checked="" type="checkbox"/>	<input checked="" type="checkbox"/>	<input checked="" type="checkbox"/>	<input checked="" type="checkbox"/>	<input checked="" type="checkbox"/>	<input checked="" type="checkbox"/>	<input checked="" type="checkbox"/>	<input checked="" type="checkbox"/>	Next >>	Show
2	Enable	<input checked="" type="checkbox"/>	<input checked="" type="checkbox"/>	<input type="checkbox"/>	<input type="checkbox"/>	<input type="checkbox"/>	<input type="checkbox"/>	<input type="checkbox"/>	<input type="checkbox"/>	<input type="checkbox"/>	<input type="checkbox"/>	<input type="checkbox"/>	<input type="checkbox"/>	Next >>	Show
3	Enable	<input type="checkbox"/>	<input type="checkbox"/>	<input type="checkbox"/>	<input checked="" type="checkbox"/>	<input checked="" type="checkbox"/>	<input type="checkbox"/>	<input type="checkbox"/>	<input type="checkbox"/>	<input type="checkbox"/>	<input type="checkbox"/>	<input type="checkbox"/>	<input type="checkbox"/>	Next >>	Show
4	Disable	<input type="checkbox"/>	<input type="checkbox"/>	<input type="checkbox"/>	<input type="checkbox"/>	<input type="checkbox"/>	<input type="checkbox"/>	<input type="checkbox"/>	<input type="checkbox"/>	<input type="checkbox"/>	<input type="checkbox"/>	<input type="checkbox"/>	<input type="checkbox"/>	Next >>	Show
5	Disable	<input type="checkbox"/>	<input type="checkbox"/>	<input type="checkbox"/>	<input type="checkbox"/>	<input type="checkbox"/>	<input type="checkbox"/>	<input type="checkbox"/>	<input type="checkbox"/>	<input type="checkbox"/>	<input type="checkbox"/>	<input type="checkbox"/>	<input type="checkbox"/>	Next >>	Show
6	Disable	<input type="checkbox"/>	<input type="checkbox"/>	<input type="checkbox"/>	<input type="checkbox"/>	<input type="checkbox"/>	<input type="checkbox"/>	<input type="checkbox"/>	<input type="checkbox"/>	<input type="checkbox"/>	<input type="checkbox"/>	<input type="checkbox"/>	<input type="checkbox"/>	Next >>	Show
7	Disable	<input type="checkbox"/>	<input type="checkbox"/>	<input type="checkbox"/>	<input type="checkbox"/>	<input type="checkbox"/>	<input type="checkbox"/>	<input type="checkbox"/>	<input type="checkbox"/>	<input type="checkbox"/>	<input type="checkbox"/>	<input type="checkbox"/>	<input type="checkbox"/>	Next >>	Show
8	Disable	<input type="checkbox"/>	<input type="checkbox"/>	<input type="checkbox"/>	<input type="checkbox"/>	<input type="checkbox"/>	<input type="checkbox"/>	<input type="checkbox"/>	<input type="checkbox"/>	<input type="checkbox"/>	<input type="checkbox"/>	<input type="checkbox"/>	<input type="checkbox"/>	Next >>	Show
9	Disable	<input type="checkbox"/>	<input type="checkbox"/>	<input type="checkbox"/>	<input type="checkbox"/>	<input type="checkbox"/>	<input type="checkbox"/>	<input type="checkbox"/>	<input type="checkbox"/>	<input type="checkbox"/>	<input type="checkbox"/>	<input type="checkbox"/>	<input type="checkbox"/>	Next >>	Show
10	Disable	<input type="checkbox"/>	<input type="checkbox"/>	<input type="checkbox"/>	<input type="checkbox"/>	<input type="checkbox"/>	<input type="checkbox"/>	<input type="checkbox"/>	<input type="checkbox"/>	<input type="checkbox"/>	<input type="checkbox"/>	<input type="checkbox"/>	<input type="checkbox"/>	Next >>	Show
11	Disable	<input type="checkbox"/>	<input type="checkbox"/>	<input type="checkbox"/>	<input type="checkbox"/>	<input type="checkbox"/>	<input type="checkbox"/>	<input type="checkbox"/>	<input type="checkbox"/>	<input type="checkbox"/>	<input type="checkbox"/>	<input type="checkbox"/>	<input type="checkbox"/>	Next >>	Show
12	Disable	<input type="checkbox"/>	<input type="checkbox"/>	<input type="checkbox"/>	<input type="checkbox"/>	<input type="checkbox"/>	<input type="checkbox"/>	<input type="checkbox"/>	<input type="checkbox"/>	<input type="checkbox"/>	<input type="checkbox"/>	<input type="checkbox"/>	<input type="checkbox"/>	Next >>	Show

PoE Ports

Profile Function

PoE Schedule 2 Information

Include Port Number											
01	02	03	04	05	06	07	08	09	10	11	12
<input checked="" type="checkbox"/>	<input checked="" type="checkbox"/>	<input type="checkbox"/>	<input type="checkbox"/>	<input type="checkbox"/>	<input type="checkbox"/>	<input type="checkbox"/>	<input type="checkbox"/>	<input type="checkbox"/>	<input type="checkbox"/>	<input type="checkbox"/>	<input type="checkbox"/>

PoE Schedule 2																								
Hour	00	01	02	03	04	05	06	07	08	09	10	11	12	13	14	15	16	17	18	19	20	21	22	23
Sun.																								
Mon.																								
Tue.																								
Wed.																								
Thu.																								
Fri.																								
Sat.																								

profile status

PoE Schedule

PoE Schedule 1																								
Hour	00	01	02	03	04	05	06	07	08	09	10	11	12	13	14	15	16	17	18	19	20	21	22	23
Sun.																								
Mon.																								
Tue.																								
Wed.																								
Thu.																								
Fri.																								
Sat.																								

Schedule of PoE power supplies. (Weeks and Hours)

Product Features – PoE Power Status

PoE Port Consumption Status

Refresh

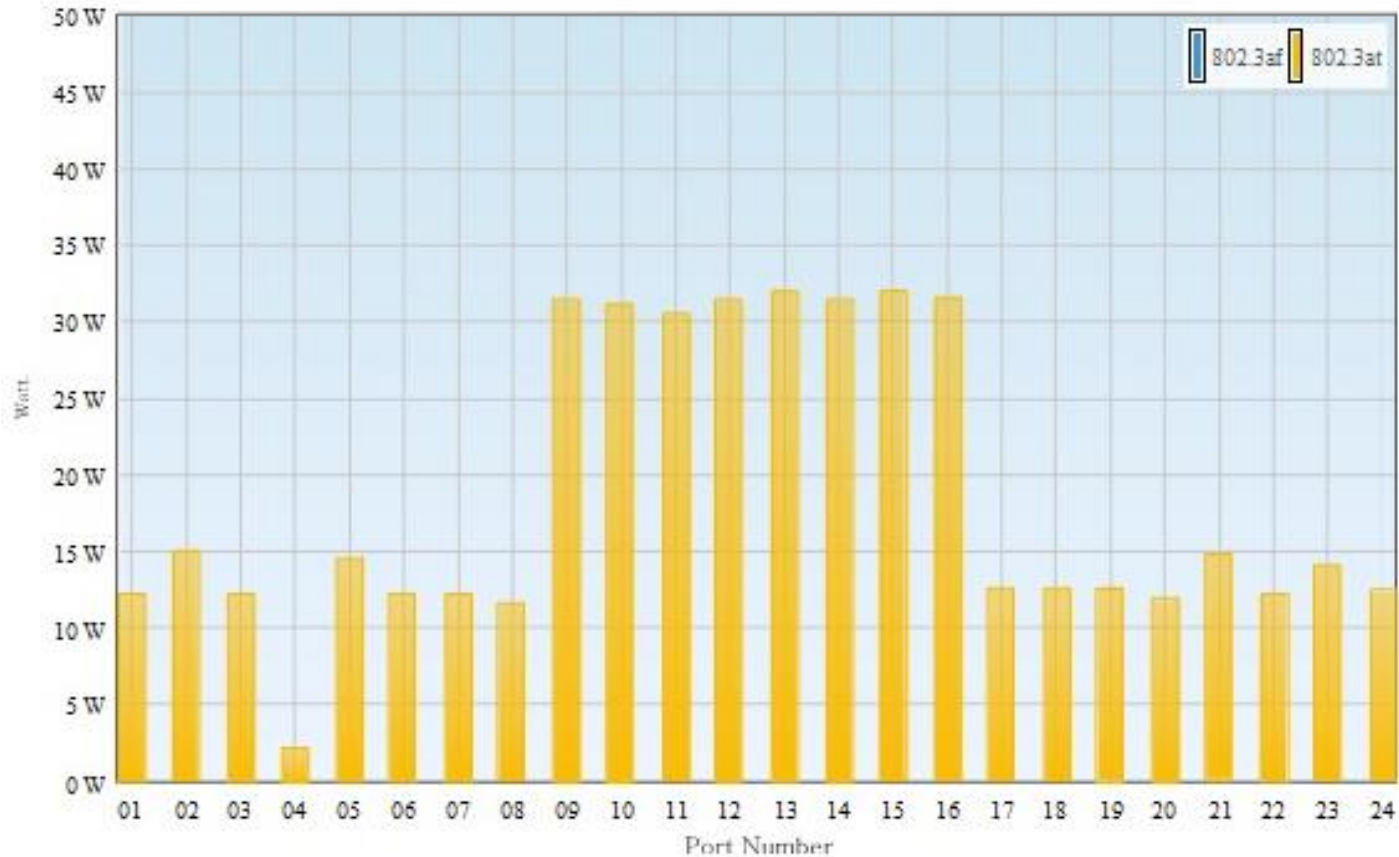

Per Port PoE Usage Chart

Product Features

◆ System Management

- ✓ **HTTP** remote Web management
- ✓ **Network Time Protocol (NTP)**
 - System time synchronization
- ✓ **SNMP** management and **SNMP Trap**
 - SNMP trap for interface Link Up ,Link Down, PoE power on, PoE power off notification
- ✓ **DHCP Client**
- ✓ **Firmware upgrade and Configuration backup / restore by HTTP**
- ✓ **System Log and Syslog**
 - System log could be logged to the Hub and remote server

Product Features

◆ PoE IP Telephony Office

- ✓ **The Gigabit High Power PoE Injector Hub** provides the easiest way to power your Ethernet devices such as IP Camera on the ceiling and the Wireless Access Point installed on the top of the building.
- ✓ To control the power system of your networking devices, HPOE-1200G / HPOE-2400G can directly co-work with PoE IP phone to build VoIP telephony network in the office.

Applications





**IEEE 802.3at
30 watts**



**IEEE 802.3af
15.4 watts**





Product Comparison – HPOE-1200G

Vendor	PLANET	PLANET
Model Name	HPOE-1200G(V2)	HPOE-1200G(V1)
Product Outlook		
Hardware		
Dimensions (W x D x H)	400 x 300 x 44.5mm	400 x 300 x 44.5mm
Power Input	100~240V AC	100~240V AC
Operating Temperature	0~50°C	0~50°C
Interface		
"Data" Input Port	12	12
"Data + Power" Output Port	12	12
No. of 802.3at / 802.3af Port	12 / Backward Compatible	12 / Backward Compatible
Data Rate	10/100/1000Mbps	10/100/1000Mbps
Management Port	10/100Base-TX	10/100Base-TX



Product Comparison – HPOE-1200G

Vendor	PLANET	PLANET
Model Name	HPOE-1200G(V2)	HPOE-1200G(V1)
Product Outlook		
Power over Ethernet		
PoE Standard	802.3at / 802.3af	802.3at / 802.3af
Power Pin Assignment	4/5(-), 7/8(+)	4/5(-), 7/8(+)
Maximum Port Power	30W	30W
Output Power Voltage	52V DC	52V DC
PoE Power Budget@52V	360 watts	340 watts
Number of PoE Ports	12	12
Number of PD @ Class 2	12	12
Number of PD @ Class 3	12	12
Number of PD @ Class 4(30W)	12	11
Power Limit Protection	■	■
Over Temperature Protection	■	■
PoE Schedule	■	■
PD Alive Check	■	
PoE Status	■	
Management		
Management & Configuration	Web	Web
SNMP V1, V2c	■	■
SNMP Trap	■	■
Log	Syslog, System log	Syslog, System log
Time Setting	SNTP	SNTP
Configuration Back up / Restore	■	■

Product Comparison – HPOE-2400G

Vendor	PLANET	PLANET
Model Name	HPOE- 2400G(V2)	HPOE- 2400G(V2)
Product Outlook		
Hardware		
Dimensions (W x D x H)	400 x 300 x 44.5mm	400 x 300 x 44.5mm
Power Input	100~240V AC	100~240V AC
Operating Temperature	0~50°C	0~50°C
Interface		
"Data" Input Port	24	24
"Data + Power" Output Port	24	24
No. of 802.3at / 802.3af Port	24 / Backward Compatible	24 / Backward Compatible
Data Rate	10/100/1000Mbps	10/100/1000Mbps
Management Port	10/100Base-TX	10/100Base-TX

Product Comparison – HPOE-2400G

Vendor	PLANET	PLANET
Model Name	HPOE-2400G(V2)	HPOE-2400G(V1)
Product Outlook		
Power over Ethernet		
PoE Standard	802.3af / 802.3at	802.3af / 802.3at
Power Pin Assignment	4/5(-), 7/8(+)	4/5(-), 7/8(+)
Maximum Port Power	30W	30W
Output Power Voltage	52V DC	52V DC
PoE Power Budget@52V	720 watts	460 watts
Number of PoE Ports	24	24
Number of PD @ Class 2	24	24
Number of PD @ Class 3	24	24
Number of PD @ Class 4(30W)	24	14
Power Limit Protection	■	■
Over Temperature Protection	■	■
PoE Schedule	■	■
PD Alive Check	■	
PoE Status	■	
Management		
Management & Configuration	Web	Web
SNMP V1, V2c	■	■
SNMP Trap	■	■
Log	Syslog, System log	Syslog, System log
Time Setting	SNTP	SNTP
Configuration Back up / Restore	■	■

Appendix Sales Target

◆ Target Markets

- ✓ **SMB IP Communication Office**
- ✓ **System Integrator**
- ✓ **IP Surveillance integrator**
- ✓ **Hotel / Internet cafe**

◆ Profitable Products

- ✓ The following PoE devices are potential to all customers:
 - PoE Switches: FGSD-1022HP, GSD-808HP, WGSW-2620HP, WGSD-10020HP
 - PoE Splitters/Injectors/Converters: POE-162, POE-162S, GTP-80x Series, HPOE-460

- ✓ The following Outdoor Standard PoE IP Cameras/Wireless Devices are potential to all customers:
 - PoE IP Cameras: ICA-3250V/3350V/HM312/HM316/HM351/HM620
 - Standard PoE Wireless Devices: WNAP-6350/7350



ACTIVATING IP POWER